

Materials

- ① Existing slate roof, to be made good where required.
- ② Existing painted stonework, to be made good where required.
- ③ Through colour render. Type and colour TBC.
- ④ Timber cladding. Type and colour TBC.
- ⑤ Curtain walling. Type and colour TBC.
- ⑥ Metal Standing Seam Roof.
- ⑦ New roof lights.
- ⑧ Tulip Umbrellas.
- ⑨ Metal Edge detail between timber and render. TBC
- ⑩ New Dormer Windows. Type and colour TBC.

Key

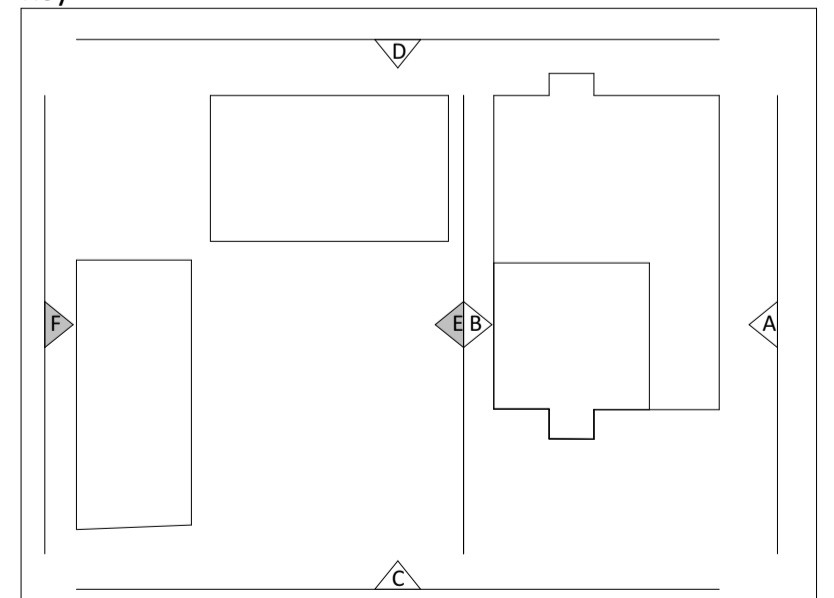

This drawing must not be scaled.
Figured dimensions and levels to be used
Any inaccuracies must be notified to the architect.

THIS DRAWING IS COPYRIGHT

Registered office: Powell Dobson Ltd, Suite 1F,
Building One, Eastern Business Park, Wern Fawr
Lane, Old St Mellons, Cardiff, CF3 5EA registered in
England & Wales No: 3873802

No.	Date	Description	By	Ap
A	18.06.18	Issued for planning	AH	AN

Planning



A1

powelldobson
ARCHITECTS

Powell Dobson Swansea
No. 2, J Shed, Kings Road, Swansea SA1 8PL

t: +44 (0)33 33 201 001
w: www.powelldobson.com

CLIENT: **Wales International Coastal Centre**

PROJECT: **Saundersfoot Harbour Regeneration**

DRAWING: Ocean Square
Proposed Elevations
Sheet 2 of 2

DATE: 13.02.2018

SCALE: 1/100 @ A1

DRAWING NUMBER:
P(0)132

DRAWN: AH

APPROVED: AN

REV:
A