

Saundersfoot Harbour

OCEAN SQUARE, PEMBROKESHIRE SA69 9HE

RETAIL + LEISURE UNITS

in the Heart of Saundersfoot overlooking
the beach + harbour



TO LET

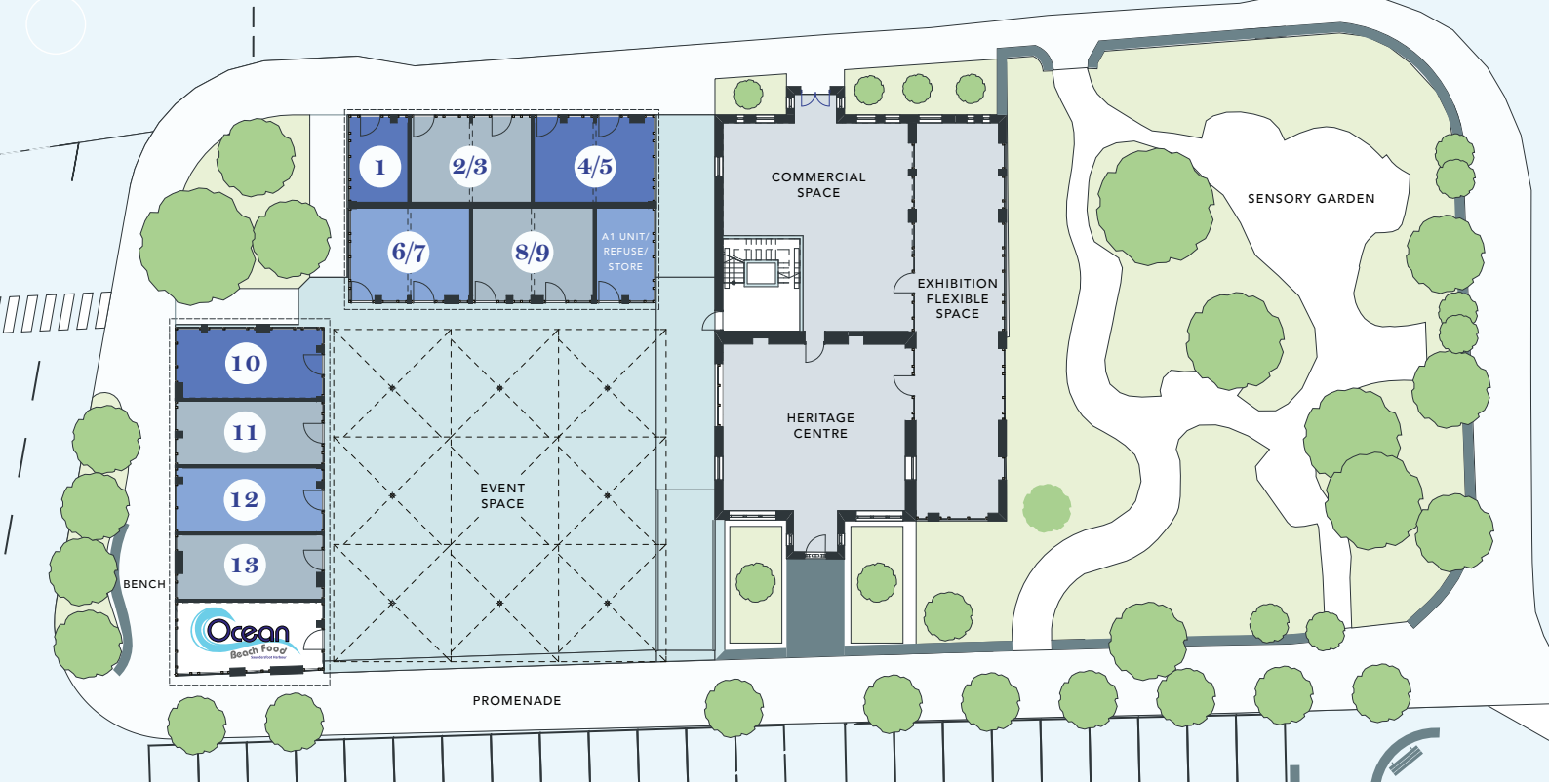

Accommodation Schedule

UNIT	SQ FT	SQ M	RENT
1	136 sqft	12.6 m ²	£7,000 pa
2/3	288 sqft	26.8 m ²	£14,750 pa
4/5	284 sqft	26.4 m ²	£14,500 pa
6/7	310 sqft	28.8 m ²	£15,750 pa
8/9	314 sqft	29.2 m ²	£15,750 pa
10	275 sqft	25.5 m ²	£14,000 pa
11	275 sqft	25.2 m ²	£14,000 pa
12	262 sqft	24.3 m ²	£13,500 pa
13	275 sqft	25.5 m ²	£14,000 pa
14			

There will be other opportunities within the Ocean Square Heritage Centre.

Lease

The units are available on short term leases for a minimum of 12 months

Rates

To be assessed but the units could qualify for Small Businesses Rates Relief as follows:

- eligible business premises with a rateable value of up to £6,000 will receive 100% relief; and
- those with a rateable value between £6,001 and £12,000 will receive relief on a tapered basis from 100% to zero

Viewing

By appointment with the agents below.

Further Information



Terry Melia
 D 029 2034 7101
 M 07775 910993
 E terry@ejhales.co.uk

Owen Cahill
 D 029 2034 7111
 M 07824 638338
 E owen@ejhales.co.uk

www.ejhales.co.uk

MISREPRESENTATION ACT 1967
 Hunters Property Investment Limited (and their joint agents if appointed) for themselves and for vendors or lessors of this property whose agents they are, give notice that: (1) The particulars are produced in good faith, are set out as a general guide only and do not constitute any part of a contract. (2) No person in the employment of the agent(s) has any authority to make or give any representation or warranty whatever in relation to this property. (3) This property is offered subject to contract and, unless otherwise stated, all rents are quoted exclusive of VAT. (4) Nothing in these particulars should be deemed to be a statement that the property is in good condition or that any services or facilities are in working order. (5) Unless otherwise stated, no investigations have been made regarding pollution or potential land, air or water contamination. Interested parties are advised to carry out their own investigations if required.

